

Building for a Healthier Tomorrow...

A multi-year fundraising campaign has been launched to support our new hospital. Our goal is to raise \$5 million toward the \$100 million we plan to invest in our community over the next several years.

We understand there are many deserving charities in our community and lots of ways to invest your philanthropic dollars. However, the construction of a brand new hospital campus is truly a once-in-a-lifetime opportunity to make an incredible impact on the health of our community.

Through your personal gift to the Building for a Healthier Tomorrow campaign, you will help to ensure that the best possible health care is available close to home for you, your family, friends and neighbors.

There are many ways to support the campaign. You can make a one-time gift or make a pledge that can be paid over 3 to 5 years. We also accept gifts of securities or gifts that will mature in the future, such as life income gifts (annuities and trusts), life insurance gifts and bequests.

Your gift to the Building for a Healthier Tomorrow campaign may be made in honor or in memory of a loved one. Commitments of \$10,000 or more are also eligible for a naming opportunity in our new hospital (see insert of naming opportunities).

To learn more, please contact St. Luke's Development Office at 484-526-3067.



Building for a Healthier Tomorrow

St. Luke's... A vital part of our community

- Each year St. Luke's Quakertown provides approximately \$6 million in charity care for patients who are underinsured or uninsured.
- St. Luke's Quakertown cares for more than 100,000 patients and provides emergency care to more than 16,000 individuals every year. Nearly 3,000 patients receive inpatient surgical care and more than 80,000 patients receive outpatient services.
- The Trauma Center at St. Luke's Quakertown Campus is the only Level IV trauma center in the region and has cared for more than 665 patients since 2016.
- Many free health-related lectures, support groups, and educational seminars are offered at the hospital throughout the year.
- St. Luke's has recruited more than 100 physicians to practice in our local community.
- St. Luke's operates one of the only two behavioral health units in Bucks County.



Charity Care Breakdown (\$6 million)

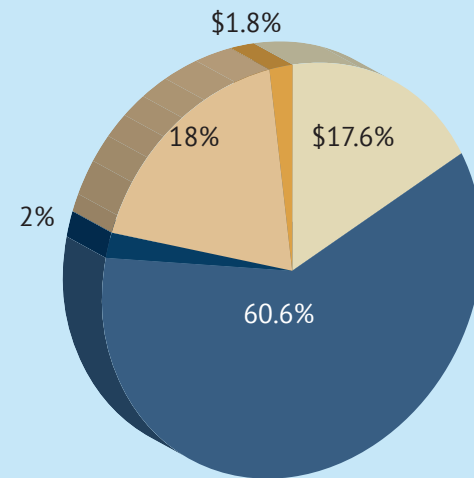

- Free or Reduced-cost care - \$1.06M
- Shortfalls from Medicaid - \$3.63M
- Community Health Improvement Services - \$120,000
- Subsidized Health Services - \$1.08M
- Donations for the Benefit of the Community - \$108,000

A Campaign for St. Luke's

For a New Hospital at
Route 663 and Portzer Road, Quakertown





A Message from our President

Since joining St. Luke's in 1995, more than \$100 million has been invested in the Quakertown campus to provide quality health care to the region. As a result, our Quakertown Campus is now regarded as one of the best community hospitals in Pennsylvania and the Nation, consistently delivering high quality, high value care. Currently, our patients have access to more than 275 physicians across 40 specialties in Bucks and Montgomery counties, and if needed, they can be referred to additional specialists across the St. Luke's University Health Network.

As part of our ongoing commitment to the health of our region, I am pleased to announce a new hospital campus at Route 663 and Portzer Road in Quakertown. With the construction of this new campus, St. Luke's is investing an additional \$100 million in Quakertown and the surrounding communities. The new facility will afford more functional, efficient space and systems, including private rooms, allowing St. Luke's to continue providing the best care, recruit the best physicians and allow for continued expansion.

Building for a Healthier Tomorrow, a fundraising effort for this project, will allow our community to participate and support a once-in-a-lifetime opportunity to significantly impact the delivery of health care in our region.

Sincerely,
Dennis Pflieger

President
St. Luke's Quakertown Campus



Rendering of main lobby

St. Luke's is developing a new 80-bed hospital on a 30-acre parcel of land at Route 663 and Portzer Road in Quakertown. With a total investment of \$100 million, this new campus will be one of the largest development projects embarked upon in the history of the Quakertown region.

The new location will include ample parking and is easily accessible to patients and their families. It is also close in proximity to many major manufacturers and local businesses and will be equipped to provide enhanced care and services to address the needs of major employers in the region.

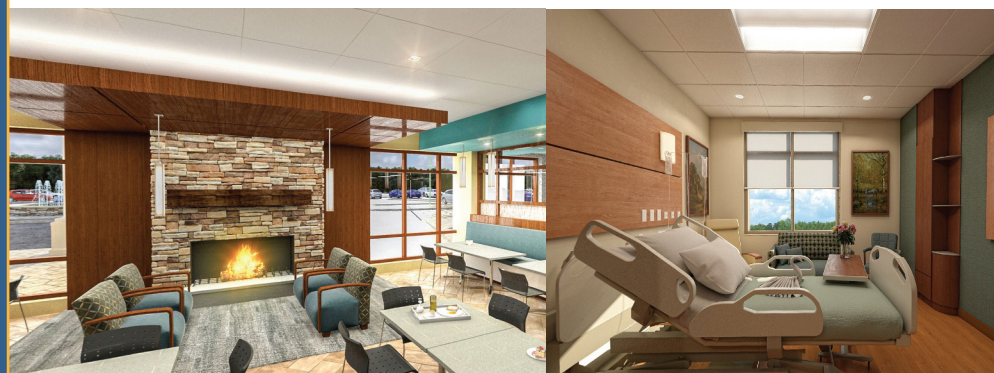

Rendering of cafeteria

Rendering of patient room

Modern hospital designed with you in mind

The new hospital will include spacious private rooms, a large emergency department, four operating rooms, and a wide array of comprehensive, state-of-the-art outpatient services. St. Luke's highly experienced physicians and clinicians will have access to the latest technological advances available to care for their patients.

Ease of access for patients and their families was our priority when designing the interior of the new facility. The layout includes registration, diagnostic testing, cafeteria and elevators within steps of entering the main lobby.

St. Luke's... A cornerstone of our community

By the mid-1990s, the health care industry was experiencing significant changes, and it was becoming more difficult for community hospitals to operate independently. In recognition of these challenges, the forward thinking board and administration of Quakertown Community Hospital joined the St. Luke's Network in 1995. Over the years, the St. Luke's Network has grown to become our region's largest and most highly regarded health care system, with 10 hospitals and over 300 locations.

Today, our Board of Trustees continues to make strategic investments in new facilities, advanced technology and the education of the next generation of healthcare providers who are studying at the Temple/St. Luke's School of Medicine and St. Luke's School of Nursing, the nation's oldest continuously operating nursing school. It is our hope that these investments will benefit you and your family for decades to come.

St. Luke's... Making a positive economic impact in our community

Economic Benefit to PA's Economy	SLUHN Quakertown Campus ¹	Ripple Benefit to PA's Economy ²	Total Economic Benefit
Total Spending	\$61,366,324	\$50,375,615	\$111,741,939
Salaries	\$24,329,247	\$14,595,115	\$38,924,362
Employees (FTEs)	384.26	318.21	702.47
Average Salary	\$63,315	\$45,867	\$55,411

1. US Department of Health & Human Services Hospital Cost Report Information System, data used from FY2016.
2. Based on regional economic multipliers from Bureau of Economic Analysis, US Department of Commerce, RIMS II Multipliers for hospital industry.

St. Luke's Quakertown Campus has an annual economic impact in our community of over \$111 million. The construction of the new hospital and the anticipated addition of 200 new jobs will generate nearly \$24.5 million in annual salaries, creating a substantial stimulus to the local economy.

Business and community leaders often cite easy access to health care as an important factor in attracting new businesses and residents. The construction of the new hospital campus is expected to stimulate further economic development in our region.

St. Luke's... Delivering quality care

- In 2016, St. Luke's Quakertown Campus was named one of the Nation's Top 100 Hospitals by Truven Analytics® in the Small Community Hospital category.
- Becker's Healthcare Review named St. Luke's Quakertown Campus to its 100 Great Community Hospitals list in 2016 and 2017.
- In 2017, St. Luke's Quakertown was awarded "A" for the commitment of keeping patients safe by The Leapfrog Group.

